

simply

Replacing a Tile



The look of a tiled wall can be ruined by a broken tile or discoloured grout. There is no need to retile the whole surface - both problems can be solved fairly easily.

TOOLS REQUIRED

Drill and Masonary Bit
Hammer
Cold Chisel
Notched Adhesive Spreader
Grout Spreader

Building made simple!

simply

Replacing a Tile

REPLACING A DAMAGED TILE

Loosen the grout around all four edges of the damaged tile with a grout raker and rake it out. Drill some holes in the centre of the tile to weaken its surface, using a power drill fitted with a ceramic tile bit. Change to a larger masonry bit to increase the size of the hole, if necessary.

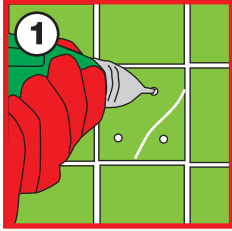

Use a hammer and cold chisel to cut through the tile between the holes and to chop out the central portion, taking care not to dig the chisel into the wall.

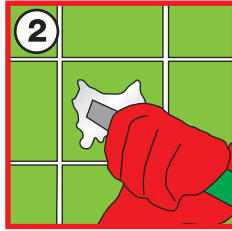

Work towards the edges of the tile, gently breaking pieces away and being especially careful as you get close to neighbouring tiles. Once the tile is removed, scrape out as much adhesive as possible.



Make sure you have removed enough adhesive by inserting the new dry tile. It should not be proud of the surrounding tiles. Coat the back of the tile with tile adhesive, using an adhesive spreader, and position it in the hole.

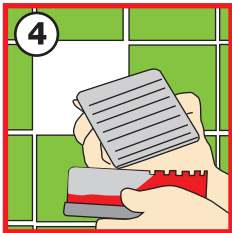

Press the tile into place with a wooden batten to ensure that it is positioned flush with the other tiles. Fit tile spacers perpendicular to the tile's surface to maintain the gap for grout and prevent the tile from slipping out of position before the adhesive is dry. When the adhesive has dried, remove the spacers and grout the tiles.

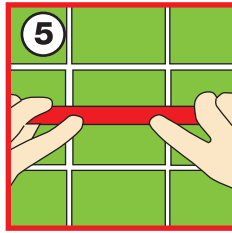

REGROUTING

Use a grout remover to remove the old grout from around the tiles to at least half the thickness of the tiles. Do all the vertical joints first and then the horizontal ones.

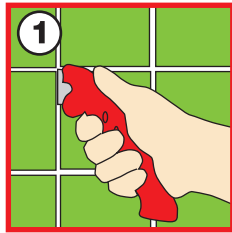

If using powdered grout, mix it with water to a creamy consistency. Use a small trowel or a grout spreader to press the grout firmly into the joints between the tiles. Move the trowel diagonally over the joints to prevent the grout being dragged out again.



Wipe excess grout from tiled surface with a damp sponge. Do not press too hard or you may remove grout from the joints.

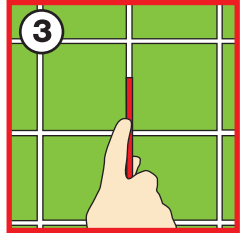

WATERPROOF SEALS

Working from one end of the splashback to the other, apply a continuous bead of sealant. Maintain a steady pressure and speed.



Any irregularity in the shape of the bead can be smoothed with a special sealant shaper, or even a soapy wet finger, take care not to pull the sealant from the surface.

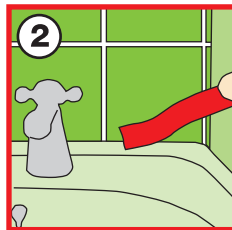

SHOULD YOU HAVE ANY FURTHER QUESTIONS, PLEASE DO NOT HESITATE TO CONTACT YOUR LOCAL BUILD IT STORE.

REGIONAL OFFICES

KWAZULU NATAL 031 508 5000	EASTERN CAPE 041 404 5000	WESTERN CAPE 021 550 7300	LOWVELD 013 753 6800
SWAZILAND 013 753 6800	SOUTH RAND 011 821 4000	NORTH RAND 011 203 5300	NAMIBIA 00264 61214201

© 2006 BUILD IT

E & O. E.

simply
Build it



Building made simple!